

Postes Cónico Circulares

Distribución de Perchas

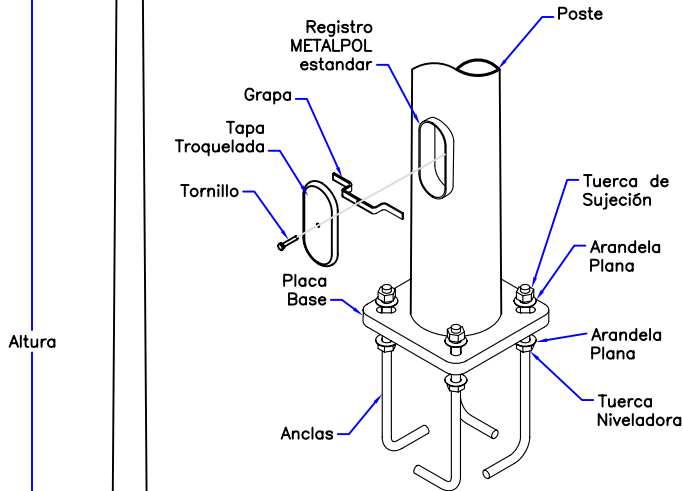

Detalle 1

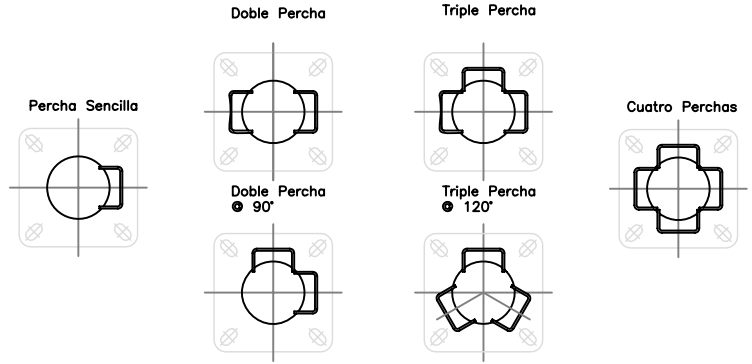
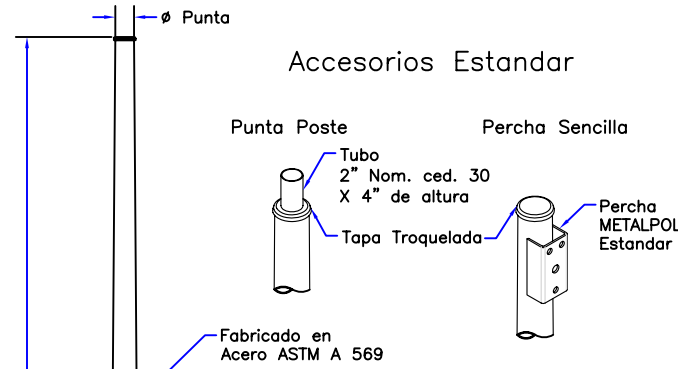
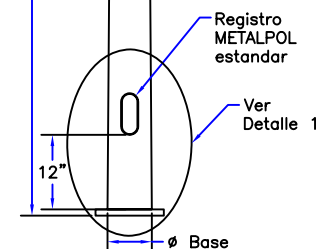
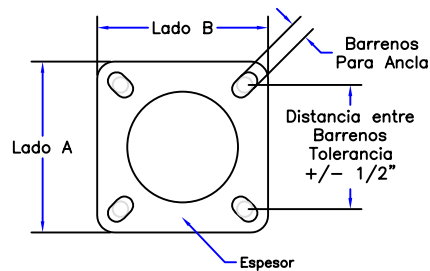

Diseño	Catalogo	Cuerpo del Poste				Placa Base				
		Base	Punta	Altura	Calibre	Lado A	Lado B	Espesor	Dist/Barr	B P/Ancias
Esbelto	3 - mp cir - 3.8	3.76 " x	2.38 " x	3 m.	12 USG	10 " x	10 " x	5/8 "	7 1/2 "	3/4 "
Medio	3 - mp cir - 4.1	4.13 " x	2.75 " x	3 m.	12 USG	10 " x	10 " x	5/8 "	7 1/2 "	3/4 "
Robusto	3 - mp cir - 4.4	4.38 " x	3.00 " x	3 m.	12 USG	10 " x	10 " x	5/8 "	7 1/2 "	3/4 "
Esbelto	3.5 - mp cir - 4.0	4.01 " x	2.40 " x	3.5 m.	12 USG	10 " x	10 " x	5/8 "	7 1/2 "	3/4 "
Medio	3.5 - mp cir - 4.4	4.36 " x	2.75 " x	3.5 m.	12 USG	10 " x	10 " x	5/8 "	7 1/2 "	3/4 "
Robusto	3.5 - mp cir - 4.6	4.60 " x	2.99 " x	3.5 m.	12 USG	10 " x	10 " x	5/8 "	7 1/2 "	3/4 "
Esbelto	4 - mp cir - 4.2	4.22 " x	2.38 " x	4 m.	12 USG	10 " x	10 " x	5/8 "	7 1/2 "	3/4 "
Medio	4 - mp cir - 4.6	4.59 " x	2.75 " x	4 m.	12 USG	10 " x	10 " x	5/8 "	7 1/2 "	3/4 "
Robusto	4 - mp cir - 4.7	4.70 " x	2.86 " x	4 m.	12 USG	10 " x	10 " x	5/8 "	7 1/2 "	3/4 "
Esbelto	4.5 - mp cir - 4.5	4.45 " x	2.38 " x	4.5 m.	12 USG	10 " x	10 " x	5/8 "	7 1/2 "	3/4 "
Medio	4.5 - mp cir - 4.8	4.82 " x	2.75 " x	4.5 m.	12 USG	10 " x	10 " x	5/8 "	7 1/2 "	3/4 "
Robusto	4.5 - mp cir - 5.1	5.07 " x	3.00 " x	4.5 m.	12 USG	10 " x	10 " x	5/8 "	7 1/2 "	3/4 "
Esbelto	5 - mp cir - 4.7	4.70 " x	2.40 " x	5 m.	12 USG	10 " x	10 " x	5/8 "	7 1/2 "	3/4 "
Medio	5 - mp cir - 5.1	5.05 " x	2.75 " x	5 m.	12 USG	10 " x	10 " x	5/8 "	7 1/2 "	3/4 "
Robusto	5 - mp cir - 5.3	5.30 " x	3.00 " x	5 m.	12 USG	10 " x	10 " x	5/8 "	7 1/2 "	3/4 "
Esbelto	5.5 - mp cir - 4.9	4.91 " x	2.38 " x	5.5 m.	12 USG	10 " x	10 " x	5/8 "	7 1/2 "	3/4 "
Medio	5.5 - mp cir - 5.3	5.28 " x	2.75 " x	5.5 m.	12 USG	10 " x	10 " x	5/8 "	7 1/2 "	3/4 "
Robusto	5.5 - mp cir - 5.5	5.53 " x	3.00 " x	5.5 m.	12 USG	10 " x	10 " x	5/8 "	7 1/2 "	3/4 "
Esbelto	6 - mp cir - 5.2	5.16 " x	2.40 " x	6 m.	11 USG	11 " x	11 " x	3/4 "	7 1/2 "	3/4 "
Medio	6 - mp cir - 5.8	5.75 " x	2.99 " x	6 m.	11 USG	11 " x	11 " x	3/4 "	7 1/2 "	3/4 "
Robusto	6 - mp cir - 6.3	6.26 " x	3.50 " x	6 m.	11 USG	11 " x	11 " x	3/4 "	7 1/2 "	3/4 "
Esbelto	6.5 - mp cir - 5.6	5.60 " x	2.61 " x	6.5 m.	11 USG	11 " x	11 " x	3/4 "	7 1/2 "	3/4 "
Medio	6.5 - mp cir - 5.8	5.80 " x	2.81 " x	6.5 m.	11 USG	11 " x	11 " x	3/4 "	7 1/2 "	3/4 "
Robusto	6.5 - mp cir - 6.2	6.24 " x	3.25 " x	6.5 m.	11 USG	11 " x	11 " x	3/4 "	7 1/2 "	3/4 "
Esbelto	7 - mp cir - 5.8	5.82 " x	2.60 " x	7 m.	11 USG	11 " x	11 " x	3/4 "	7 1/2 "	3/4 "
Medio	7 - mp cir - 6.2	6.22 " x	3.00 " x	7 m.	11 USG	11 " x	11 " x	3/4 "	7 1/2 "	3/4 "
Robusto	7 - mp cir - 6.7	6.72 " x	3.50 " x	7 m.	11 USG	11 " x	11 " x	3/4 "	7 1/2 "	3/4 "
Esbelto	7.5 - mp cir - 6.0	6.04 " x	2.60 " x	7.5 m.	11 USG	11 " x	11 " x	3/4 "	7 1/2 "	3/4 "
Medio	7.5 - mp cir - 6.4	6.44 " x	3.00 " x	7.5 m.	11 USG	11 " x	11 " x	3/4 "	7 1/2 "	3/4 "
Robusto	7.5 - mp cir - 6.8	6.84 " x	3.40 " x	7.5 m.	11 USG	11 " x	11 " x	3/4 "	7 1/2 "	3/4 "
Esbelto	8 - mp cir - 6.3	6.27 " x	2.60 " x	8 m.	11 USG	11 " x	11 " x	3/4 "	7 1/2 "	3/4 "
Medio	8 - mp cir - 6.6	6.60 " x	2.93 " x	8 m.	11 USG	11 " x	11 " x	3/4 "	7 1/2 "	3/4 "
Robusto	8 - mp cir - 7.0	7.00 " x	3.33 " x	8 m.	11 USG	11 " x	11 " x	3/4 "	7 1/2 "	3/4 "
Esbelto	9 - mp cir - 6.8	6.77 " x	2.64 " x	9 m.	11 USG	11 " x	11 " x	3/4 "	8 "	1 "
Medio	9 - mp cir - 7.1	7.13 " x	3.00 " x	9 m.	11 USG	11 " x	11 " x	3/4 "	8 "	1 "
Medio2	9 - mp cir - 7.5	7.54 " x	3.41 " x	9 m.	11 USG	11 " x	11 " x	3/4 "	8 "	1 "
Robusto	9 - mp cir - 7.7	7.70 " x	3.57 " x	9 m.	11 USG	11 " x	11 " x	3/4 "	8 "	1 "
Robusto 2	9 - mp cir - 7.9	7.93 " x	3.80 " x	9 m.	11 USG	11 " x	11 " x	3/4 "	8 "	1 "
Esbelto	10 - mp cir - 7.4	7.38 " x	2.78 " x	10 m.	11 USG	11 " x	11 " x	1 "	8 "	1 "
Medio	10 - mp cir - 7.6	7.59 " x	3.00 " x	10 m.	11 USG	11 " x	11 " x	1 "	8 "	1 "
Robusto	10 - mp cir - 8.1	8.09 " x	3.50 " x	10 m.	11 USG	12 " x	12 " x	1 "	9 1/4 "	1 "
Esbelto	11 - mp cir - 7.7	7.65 " x	2.60 " x	11 m.	11 USG	11 " x	11 " x	1 "	8 "	1 "
Medio	11 - mp cir - 8.1	8.10 " x	3.05 " x	11 m.	11 USG	12 " x	12 " x	1 "	9 1/4 "	1 "
Robusto	11 - mp cir - 8.8	8.80 " x	3.75 " x	11 m.	11 USG	13 " x	13 " x	1 "	10 "	1 "
Esbelto	12 - mp cir - 8.1	8.10 " x	2.59 " x	12 m.	11 USG	12 " x	12 " x	1 "	9 1/4 "	1 "
Medio	12 - mp cir - 8.5	8.51 " x	3.00 " x	12 m.	11 USG	13 " x	13 " x	1 "	10 "	1 "
Robusto	12 - mp cir - 9.0	9.00 " x	3.49 " x	12 m.	11 USG	13 " x	13 " x	1 "	10 "	1 "
C. de Garza	10 - mp cir - 7.5	7.47 " x	2.60 " x	10 m.	11 USG	11 " x	11 " x	1 "	8 "	1 "

Especificación:

Poste Cónico Circular, fabricados en una sola sección con un solo cordón de soldadura y penetración mínima de 80% bajo el proceso GMAW, y cumple con los requerimientos de AWS D 1.1, 2006, garantizando de esta manera la uniformidad, fusión y penetración indicada en este código, evitando los defectos de discontinuidad, porosidad, socavado, falta de fusión y falta de penetración.
Sin anillos o cartabones en la placa base.
Libre de marcas como tableteo, pandeamiento, torcimiento o golpes.

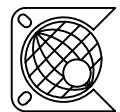

METALPOL

Santiago Papisquiario N° 158 Parque Industrial Lagunero Gómez Palacio, Dgo.
www.metalpol.com.mx email: sales@metalpol.com.mx